



New Reopening Hours:

Monday: 10:00 a.m. – 5:00 p.m.

Tuesday: 10:00 a.m. – 5:00 p.m.

Wednesday: Closed for Deep Cleaning

Thursday: 10:00 a.m. – 5:00 p.m.

Friday: 10:00 a.m. – 5:00 p.m.

Saturday: 10:00 a.m. – 5:00 p.m.

Sunday: 12:00 p.m. – 5:00 p.m.

Admission Includes:

- Four floors of interactive exhibit galleries.
- Giant-Screen Films in the Dr. Phillips CineDome.
- Educational Films in the Digital Adventure Theater.

Did You Know...

- The Orlando Science Center offers: camps, classes, birthdays and afterschool programs! Visit us online at www.osc.org/education or call **407.514.2112** for more info.

Level 1

NatureWorks

This hands-on exhibit hall celebrates the natural world, with a special focus on the diverse ecosystems of Central Florida. Visitors discover the insects, plants and animals of coral reefs, salt marshes, mangrove swamps and other Florida environments.

Dr. Phillips CineDome

Be transported to exotic lands without ever leaving home, with images of extraordinary clarity and depth that surround the audience using the largest film format in existence.

Level 3

The Hive: A Makerspace Presented by The Isaacs Family

The Hive is a creative space where you, the maker, are empowered to learn together, explore skills, and share ideas. *The Hive is designed specifically for makers ages 8 and up. Makers 12 and under must be accompanied by an adult.*

Fusion: A STEAM Gallery

See art from a new and exciting perspective as it's fused together with STEM. New and permanent exhibitions are featured throughout the year with an emphasis on local artists.

Level 2

KidsTown

Collect oranges, climb, splash, explore and play in our KidsTown exhibition, a special exhibit hall designed for children who are developmentally 0-7 years old.

Kinetic Zone

Explore forces and motion as you design, build, and test your own creations in a series of hands-on challenges.

Digital Adventure Theater

Featuring a 4K resolution projection system and presenting movies in a fully immersive experience.

Level 4

DinoDigs

Meet the ancient rulers of our planet as you discover dinosaurs and prehistoric sea creatures. Become part of a paleontological excavation team when you explore our interactive dig pit, Jurassic Ridge.

Our Planet

Through hands-on exhibits, discover how the atmosphere, biosphere, geosphere, and hydrosphere are connected and how the tiniest change in one can dramatically affect the others.

OSC Manners

Orlando Science Center was built for your enjoyment, but we reserve the right to terminate the visit of any individual or group that is inadequately supervised or fails to conform to good standards of behavior; vandalizes or misuses OSC property. Please know that children under the age of 12 years old must be accompanied by a responsible adult. The Science Center is LEED certified so smoking, dipping or chewing tobacco or a tobacco product must take place 25 feet from all exterior doors. No tobacco products or e-cigarettes are allowed in the facility. The possession of weapons of any kind are strictly prohibited. If someone is suspected of having a weapon in their possession, they will be detained and the necessary authorities will be contacted so a search and seizure can be conducted.

Tickets are nonrefundable or exchangeable. For your safety, no late seating or reentry while Dr. Phillips CineDome films are in progress. 3D glasses are property of Orlando Science Center; please place them in the bin when exiting the Digital Adventure Theater. Cameras or recording equipment are prohibited in the CineDome and Digital Adventure Theater. Management not responsible for items left unattended. The Science Center occasionally photographs and/or records exhibits, programs, or live performances in session for advertising and promotional use. Should you have objection to the Science Center using photographs/recordings of you or your children, please notify a staff member when you notice photography or filming being conducted for the above-mentioned reasons.

LEVEL 4

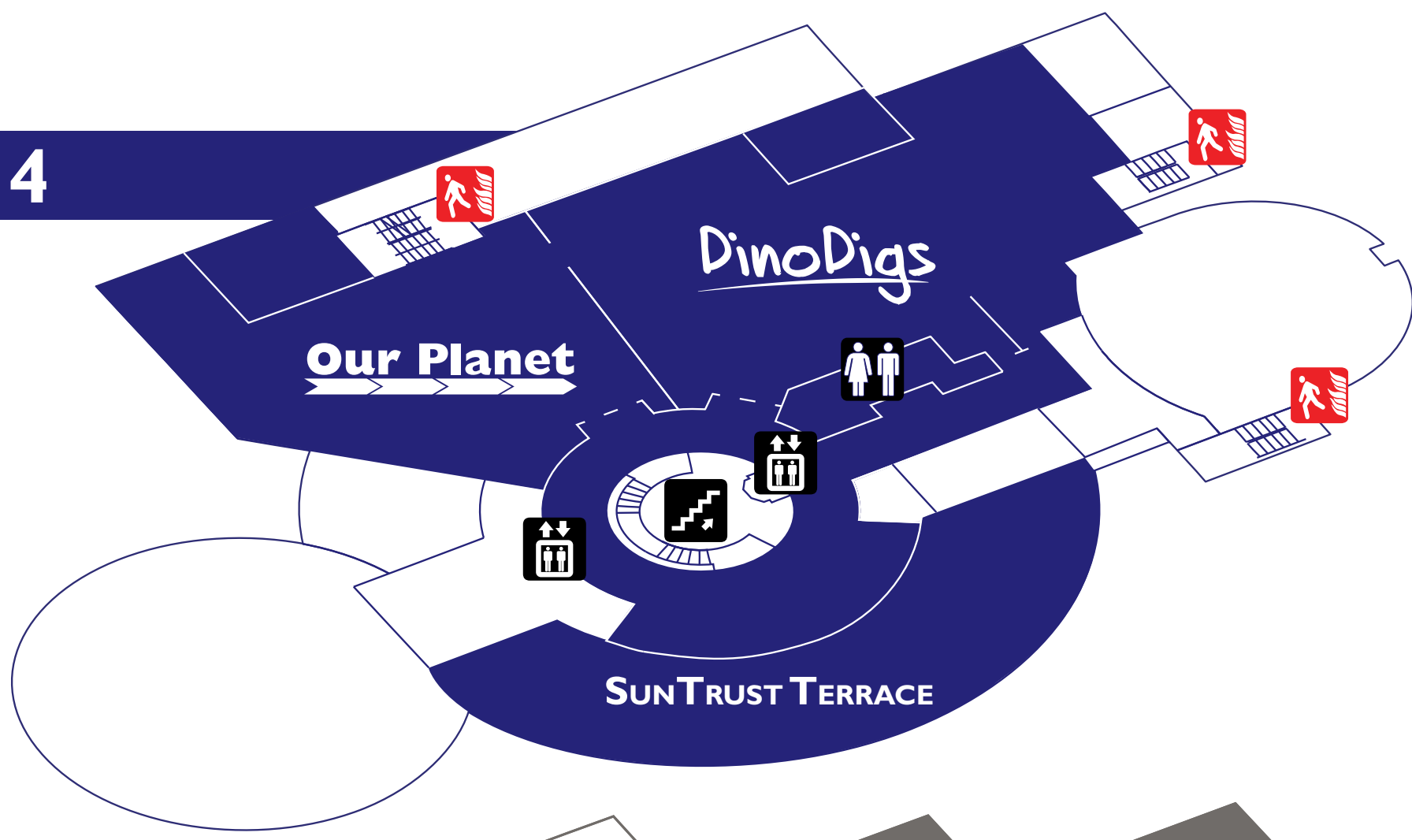

LEVEL 3

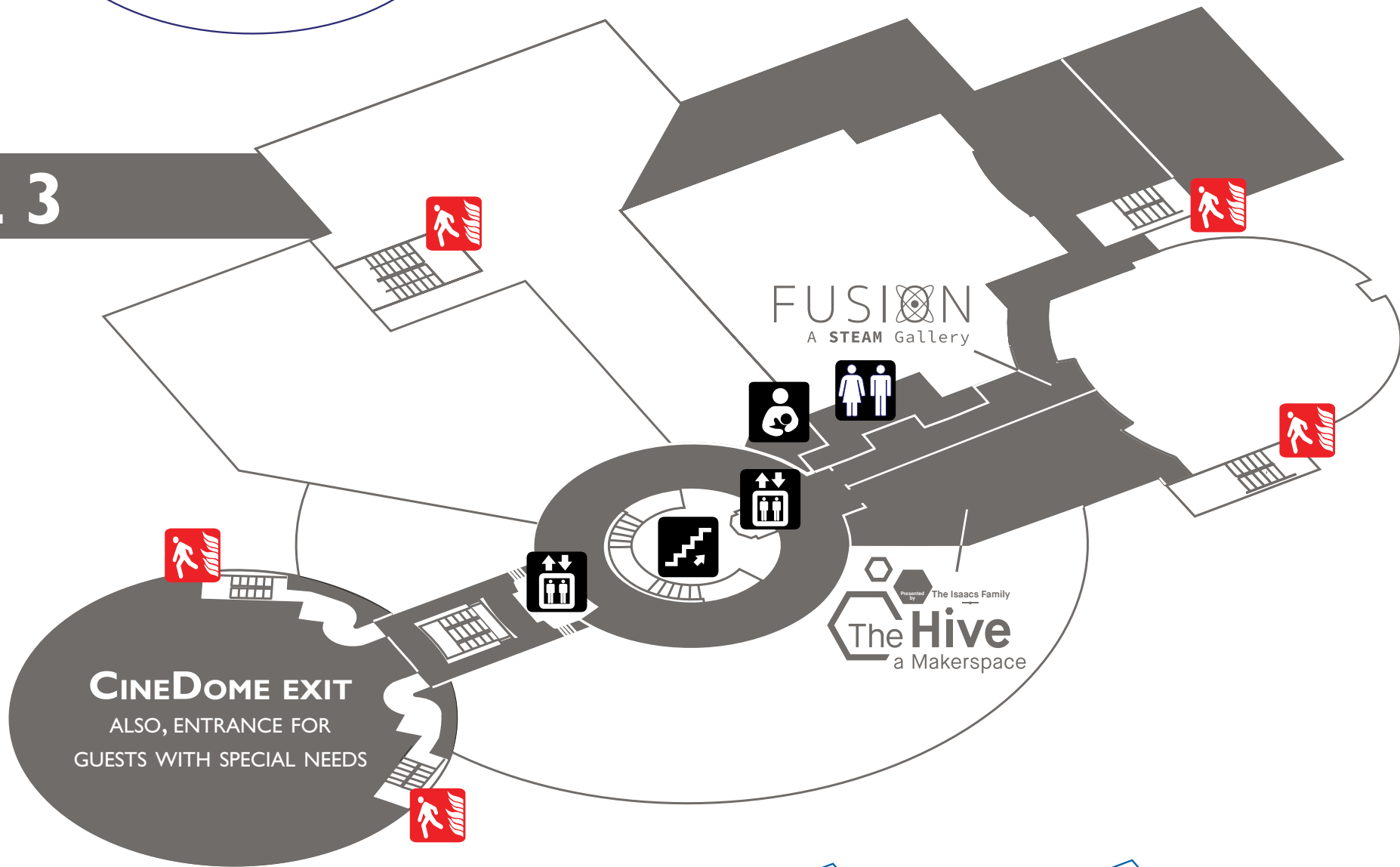

LEVEL 2



LEVEL 1

